

# St. Paul's United Methodist Church

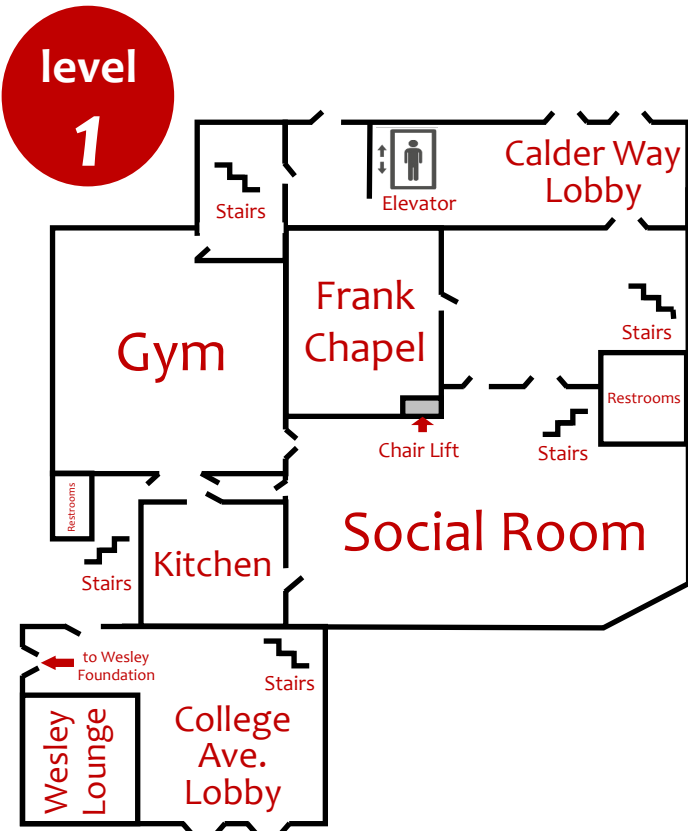

The large stone entrance step at the base of the tower is the only remaining vestige of our first church building, dedicated in 1889. A rainbow window was installed over this entrance as a reminder of the rainbow visible through the smoke and flames in the fire of 1987.

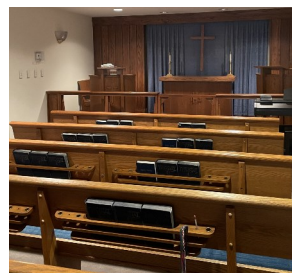

The Frank Chapel, open for prayer whenever the Church is open, was named in honor of the dedicated work of Pastor Dr. Nelson H. Frank and his wife, Katherine, who served St. Paul's 1957-1978. Its stained glass windows were designed to pictorially reflect the heritage of the United Methodist Church.

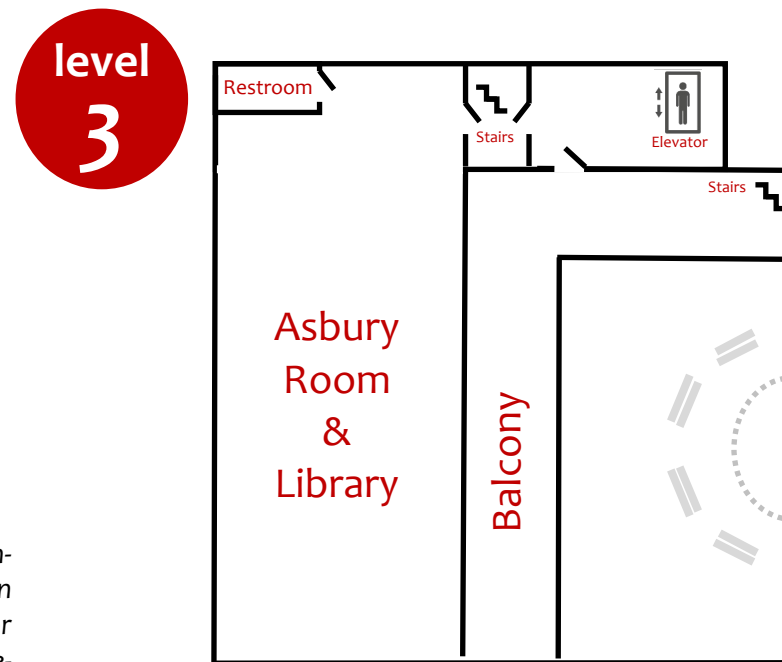

The Dobson pipe organ, which weighs about 8,400 pounds, was installed in 1990. There are 58 notes on the two manual keyboards, 32 notes on the pedalboard, and a total of 1543 pipes.



# VISITOR'S GUIDE

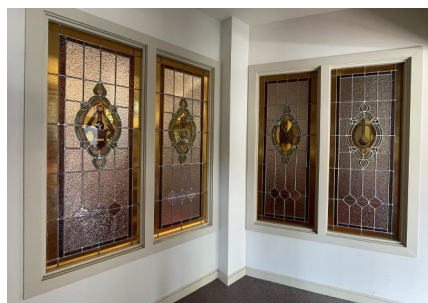
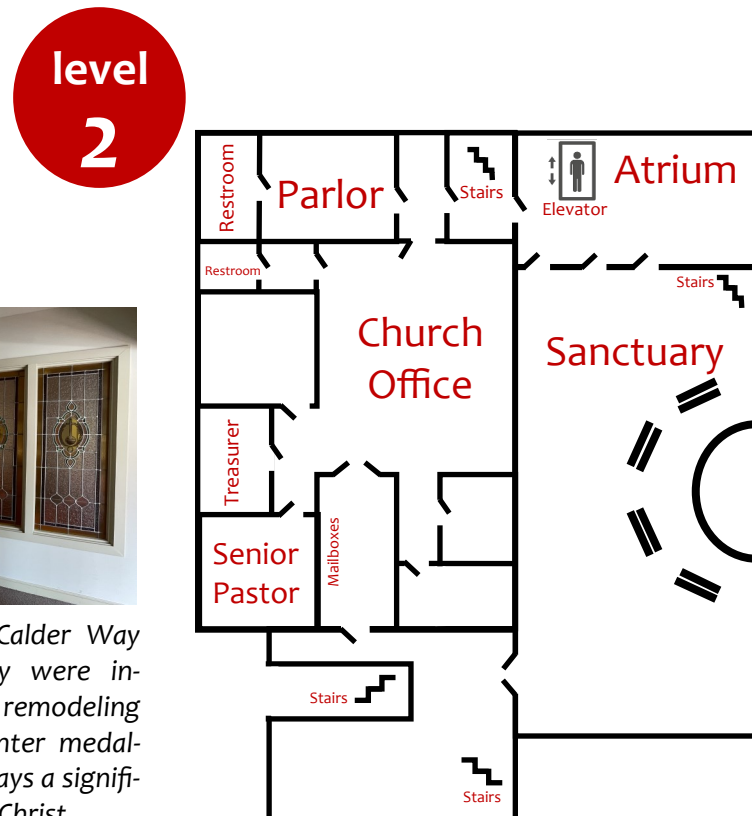

The windows of the Calder Way wall of the Sanctuary were installed during the 1986 remodeling of the church. The center medallion in each panel portrays a significant event in the life of Christ.

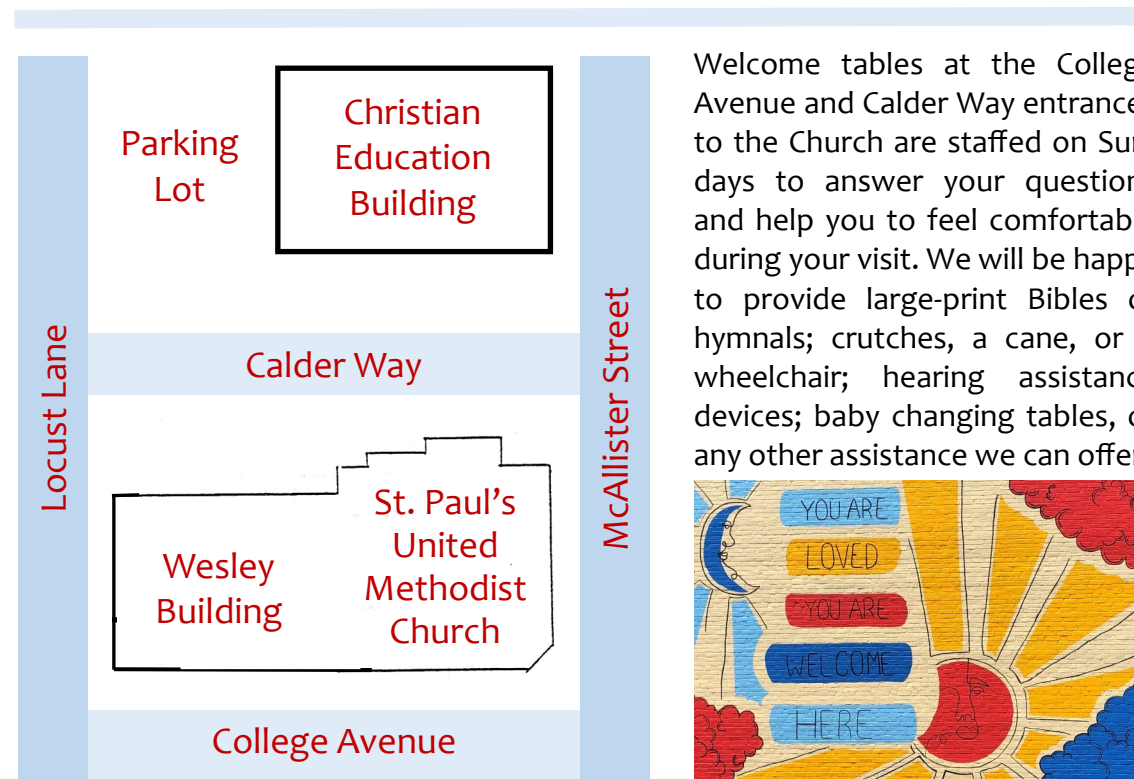

Welcome tables at the College Avenue and Calder Way entrances to the Church are staffed on Sundays to answer your questions and help you to feel comfortable during your visit. We will be happy to provide large-print Bibles or hymnals; crutches, a cane, or a wheelchair; hearing assistance devices; baby changing tables, or any other assistance we can offer.



MEETING MAKING MOVING  
**St Paul's**  
 UNITED METHODIST CHURCH &  
 WESLEY FOUNDATION

250 E College Ave  
 State College, PA 16801  
 814-237-2163  
 stpauls@stpaulsc.org  
 www.stpaulsc.org  
 Wesley Foundation: 814-238-6739

# Wesley Building

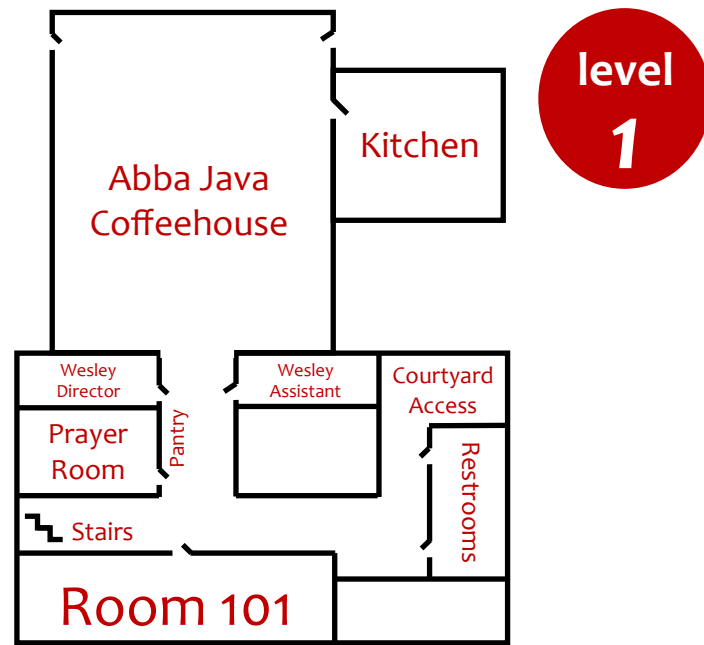

level 1

The Wesley Foundation is the center of our campus ministry mission and includes the Abba Java coffeehouse, where students will find a welcoming environment, free beverages and snacks, a free pantry, quiet study spaces, and free wifi.

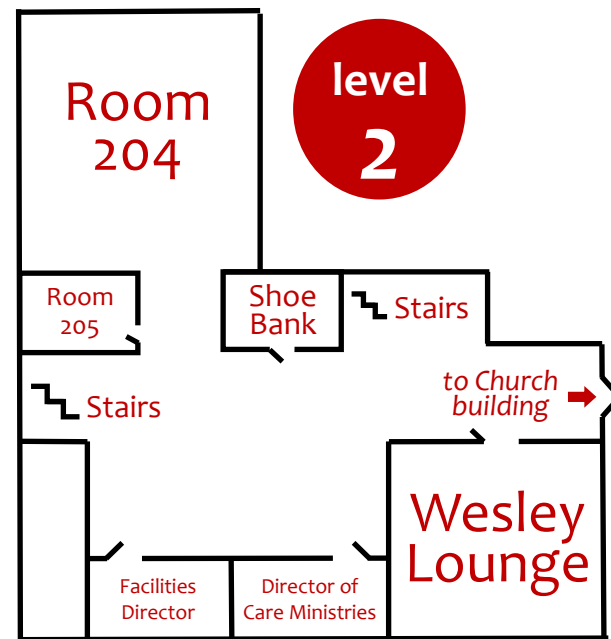

level 2

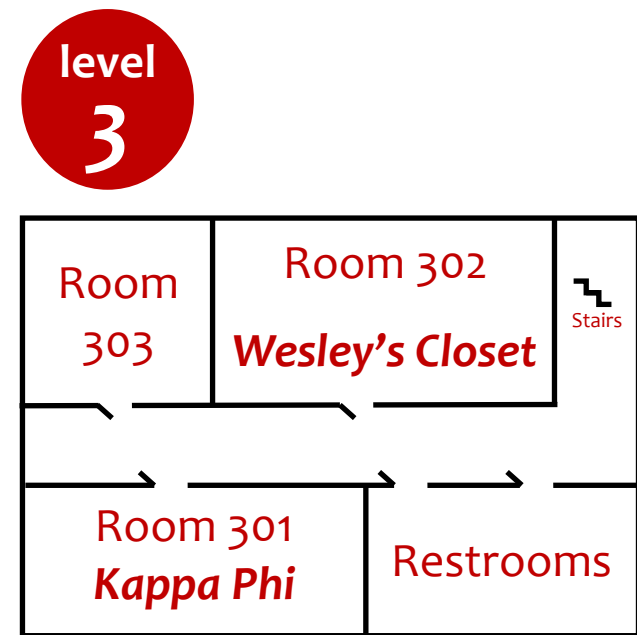

level 3



# St. Paul's United Methodist Church & Wesley Foundation Campus

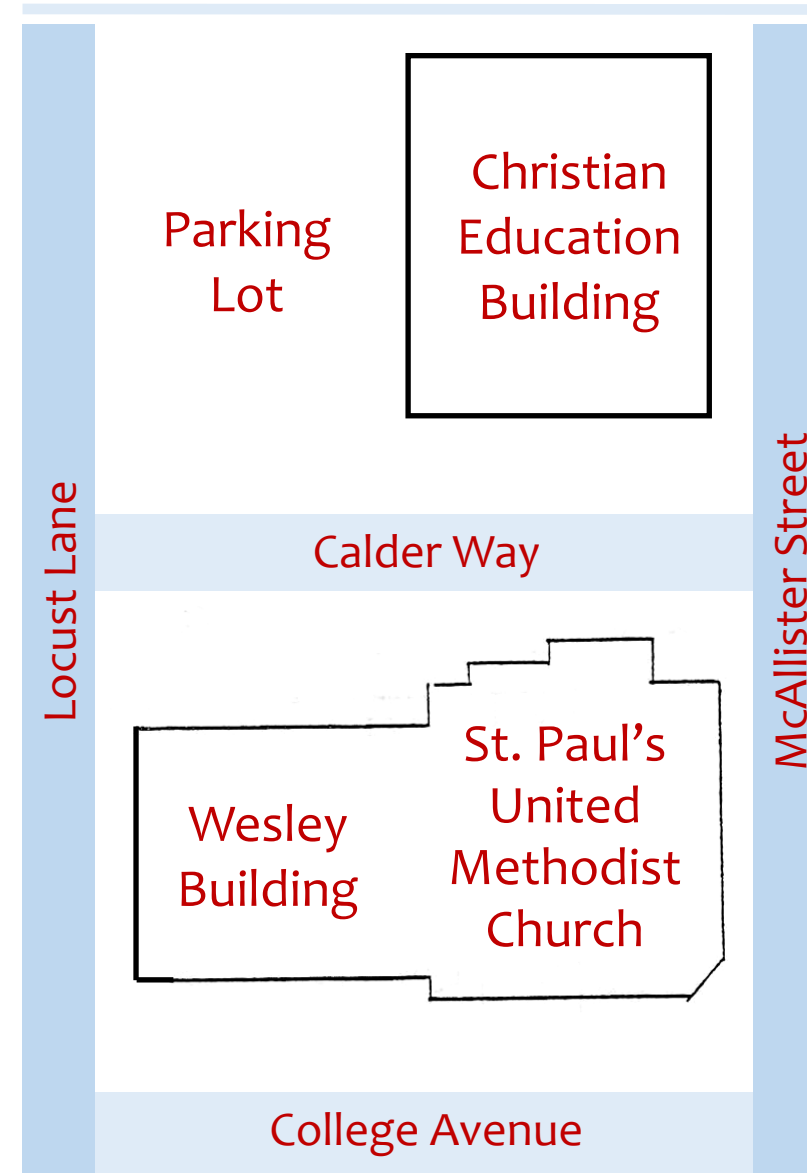

**PARKING:** The Church parking lot is reserved for staff Monday-Friday 7:00 am-5:00 pm. All other vehicles will be towed at the owner's expense. Parking is available on the street or in a nearby parking facility. After 5:00 pm, the parking lot is available to those attending Church functions.

# Education Building

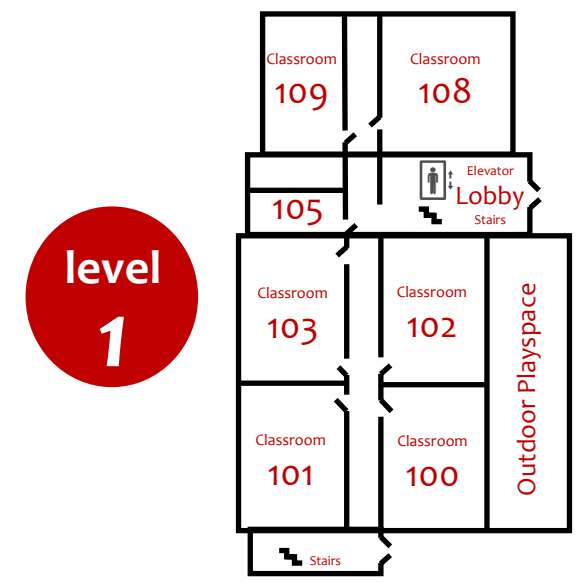

level 1

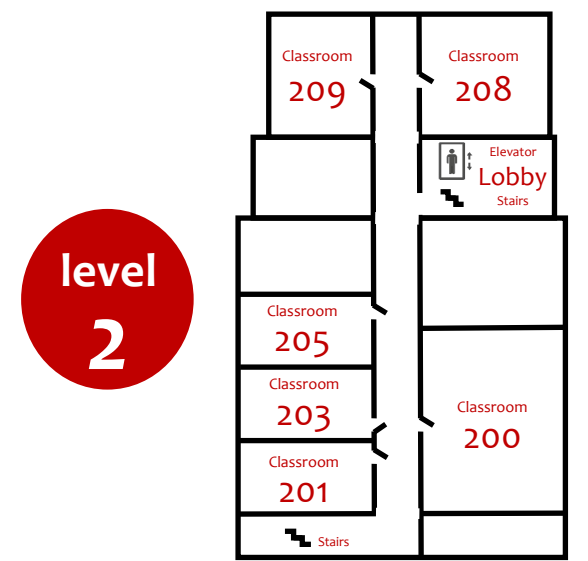

level 2

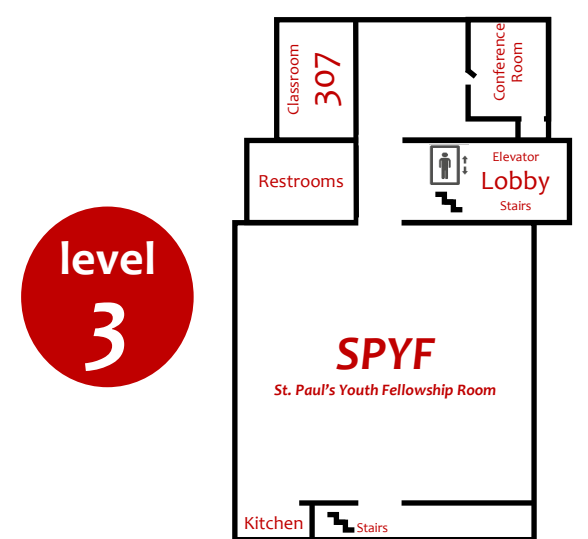

level 3